

SINGLE HANDLE PRESSURE BALANCED VALVE

INSTALLATION AND CARE GUIDE

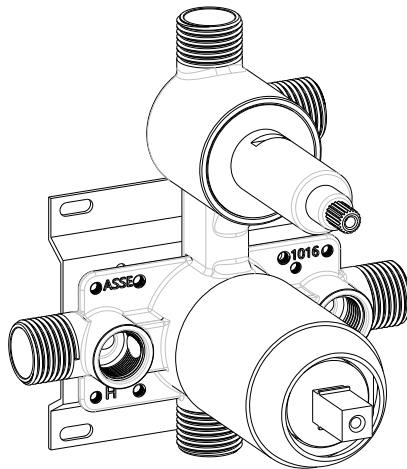

Thank You

We recommend our products be installed by a professional. We appreciate the trust and confidence you have placed in our OAKLAND products. We strive to continuously create quality products designed to enhance your home at an affordable price. Please visit our distributor's website to see our full line of products available for your home improvement needs.
www.oaklandkb.com

INSTALLATION

1.Preparing for -Installation

- A.Shut off the water supply to the tub and shower.
- B.Verify that the hole sizes and positions of the holes in the wall are correct.
- C.Ensure that the valve body cover is flush with the finished exterior surface of the wall.
Position the valve body correctly in the wall with the side marked "UP" pointing up.

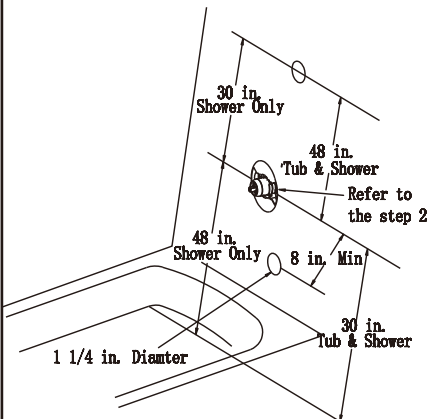

2.Installing the valve body and removing the plaster guard:

A.Thin wall Installation

"Thin Walls" are usually built up with materials such as fiberglass which will not support the valve. Please keep the plaster guard (L) attached to the valve as it will be your main source of support.

B.Thick Wall Installation

"Thick Wall" are usually built up with materials such as cement board, drywall, tile, etc. The plaster guard(L) is position so that it is flush with the finished wall. This ensures that the valve will be at the correct position to accept the trim. There will be interference between the plaster guard (L) and the Escutcheon(E). It is recommended that you remove the plaster guard (L) after the wall installation.

- C.Unscrew the screws(M) and remove the plaster guard(L).

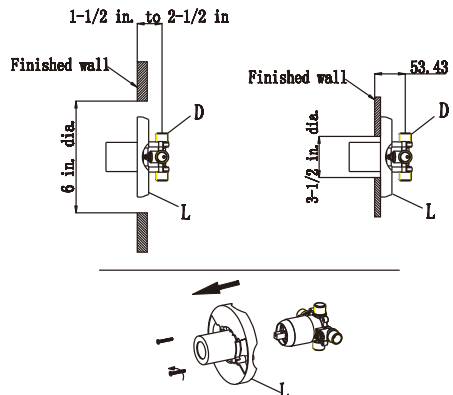

Determining Your Existing Rough-In Plumbing Installation

If you are replacing your plumbing valve, see below for four common plumbing methods. Specific rough-in fittings are **not supplied**. These may be required for installation. Remove existing handle and valve trim before replacing your valve. **Please follow all local building and plumbing codes.**

INSTALLATION

3. Secure the valve body:

Use the 2 self-tapping screws (included) to fix the valve on the back wall to avoid the valve shaking after installation.

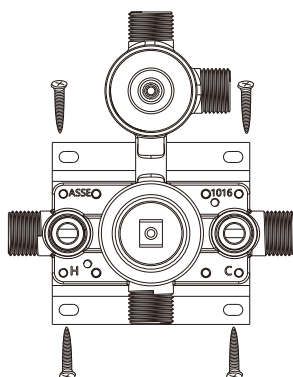

4. Installing the supply connections:

(Before soldering. Remove the cartridge & stop valves from the valve)

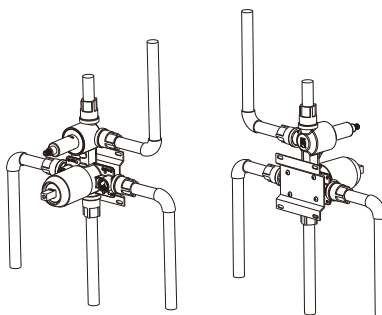

A. COPPER

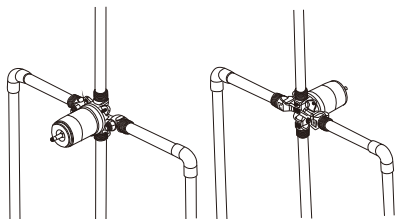

B. IPS

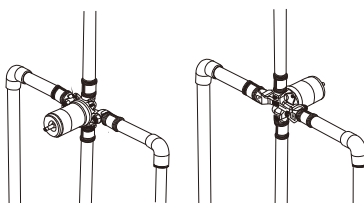

C. PEX+COPPER

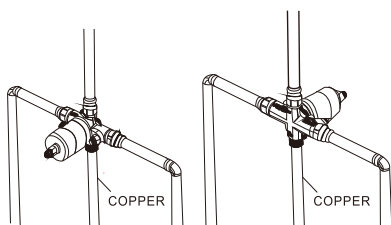

D. CPVC+COPPER

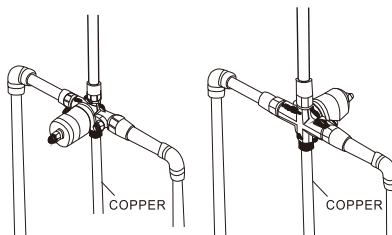

INSTALLATION

5.Flushing the water outlet and checking for leaks:

Place the handle (G) on the valve body(D) inverter and turn the handle to full on mixed position. Turn on the hot and cold water supply lines and allow the water to flow from outlets for one minute, or until all foreign matter has been flushed out. Check for leaks. Shut off the water at the faucet and supply lines. Remove the handle (G).

6.Installing the plaster guard

Place the plaster on the the valve body and secure with the screws.

